

Avery Dennison®

TrafficJet™ Front Panel functions

Instructional Bulletin : # 9.11
Revision : # 02
Last Updated : June 2018

Contents

1. Power Indicator
2. Head Height Indicator
3. Menu Button
4. Cancel / Pause Button
5. Arrow Buttons
6. Enter / Cut Sheet Button
7. Cleaning Mode Indicator
8. Error Indicator
9. Online Menu

1. Power Indicator

Button is Blue when the printer is ON and in Standby Mode. The button blinks when receiving data from the RIP software.

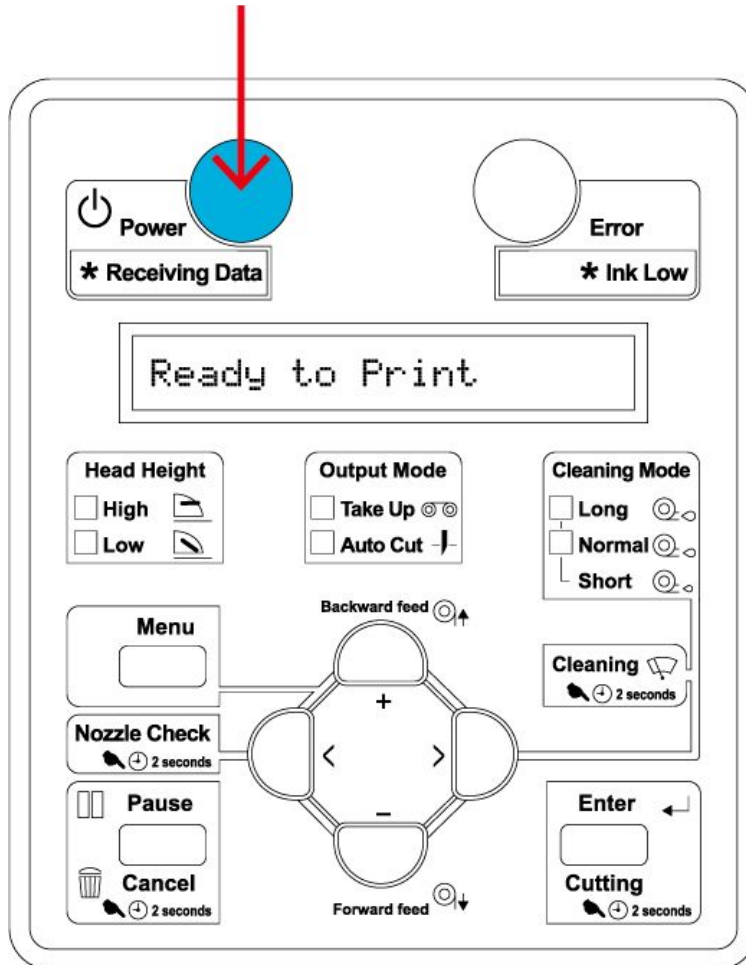

2. Head Height Indicator

Important!

- Mid Position is the correct position for the TrafficJet when printing on Reflective Sheeting.
- Some older TrafficJet models might refuse to switch OFF if the head height is in Mid position. Switching the orange lever to LOW position when turning OFF the printer fixes this issue.

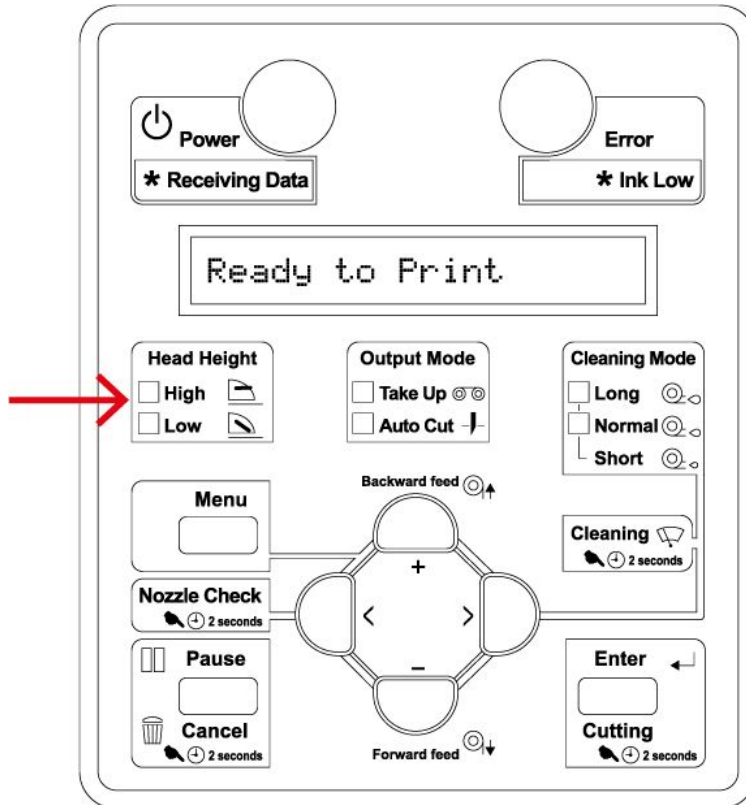

Indicator Head Height Low Position

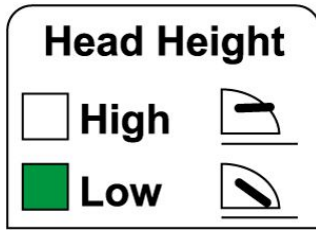

Indicator Head Height Mid Position (correct position for Reflective Sheeting)

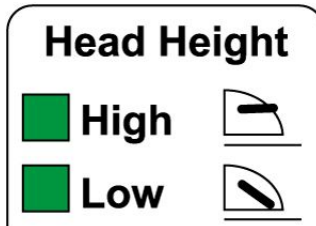

Indicator Head Height High Position

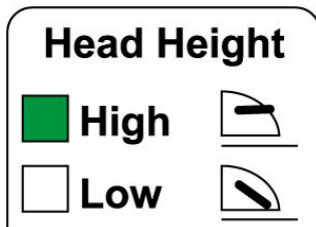

3. Menu Button

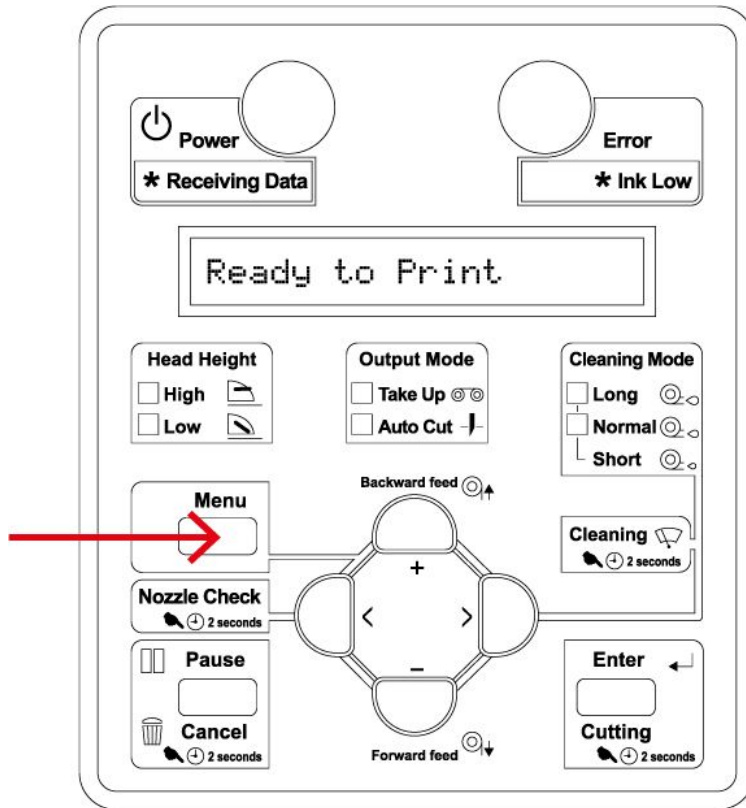

Enter the Menu Panel Menu. See table on the next page for the 7 menu sections.

Menu 1:	Setup >	Setup Table is not part of this Instructional Bulletin	
Menu 2:	Test Print >	Test 1:	Nozzle Check
		Test 2:	Mode Print
		Test 3:	Setup List
		Test 4:	Palette (not for xx38)
		Test 5:	Colour Verify
Menu 3:	Cleaning >	Time:	Short
			Normal
			Long
			Little Charge
			Initial Charge
Menu 4:	Menu Option >	1 [*] Hide / Show Menu Entries of the Setup List	
Menu 5:	Version >	Ver. M / C : 3.02 / 1.20	
Menu 6:	Sleep Mode >	Sleep Mode 1	Set Timer
		Sleep Mode 2	Start
Menu 7:	Display >	Display 1:	Language
		Display 2:	Temperature
		Display 3:	Length
Menu 8:	Jobstatus >	Info about the last job	

4. Cancel / Pause Button

Double function: Cancel or pause the current print job.

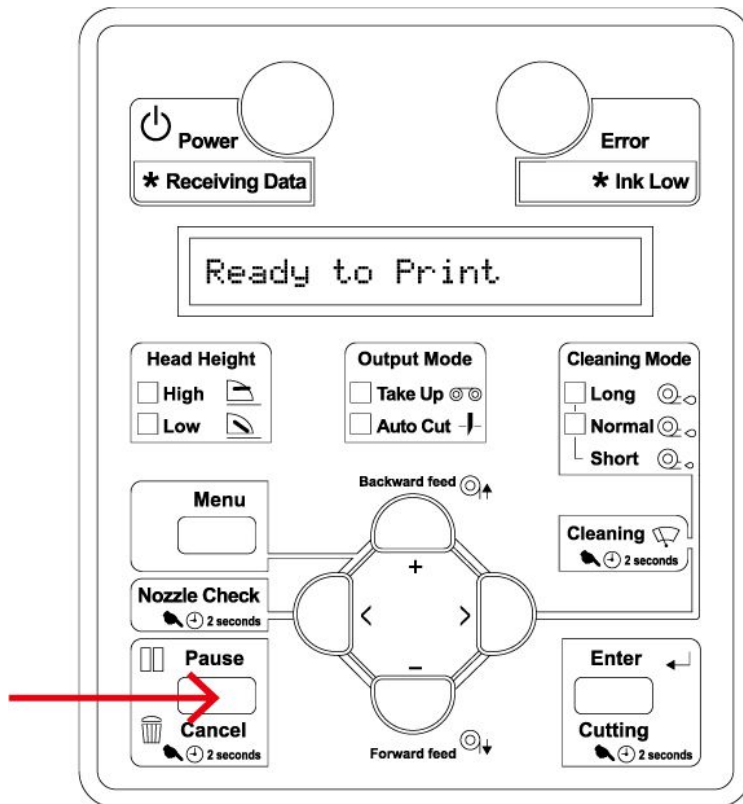

5. Arrow Buttons

Left Arrow Button

Double function. Either navigate through the menu or when printer is in Standby status, click and hold for 2 seconds to print a Nozzle Check.

Down Arrow Button

Feed sheeting forward.

Right Arrow Button

Triple function: Either navigate through the menu, click and hold for 2 seconds to perform a Manual Cleaning Cycle (works also during actual printing), in Standby mode push short to change the Manual Cleaning Cycle. For more information, visit our [website](#) and check Manual Cleaning Cycle IB# 9.9.

Up Arrow Button

Feed sheeting backward.

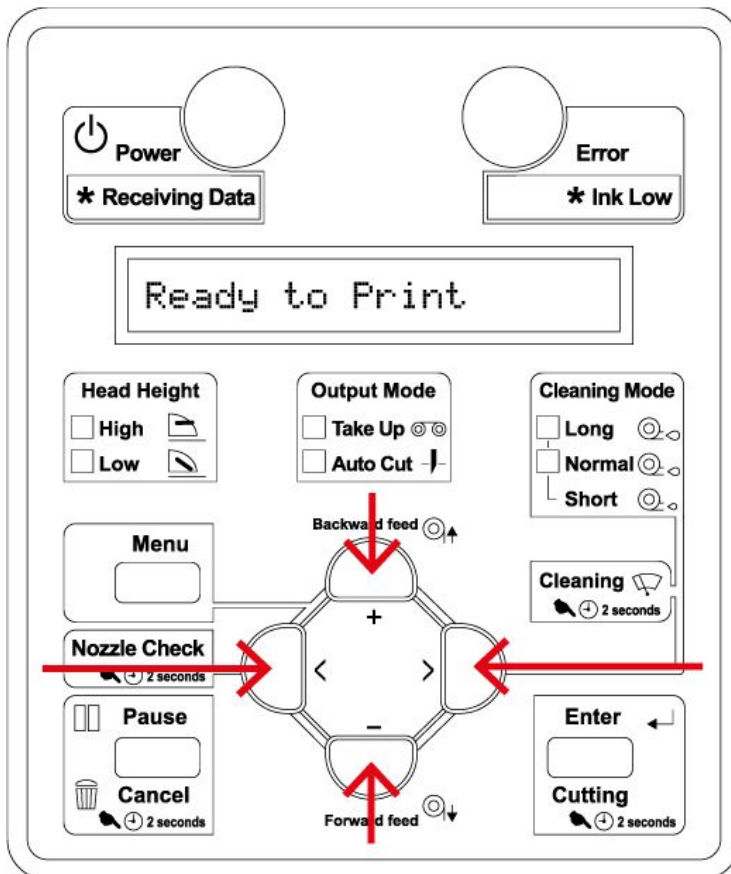

6. Enter / Cut Sheet Button

Triple function. Press to confirm option when navigating through the Menu, click to resume printing when printer is in Pause Mode and click and hold for 2 seconds when printer is in Standby Mode to cut off sheeting.

Important!

ONLY use the automatic cutter to cut T-1500D or Avery Dennison Graphics media. **DO NOT** use for any other (Prismatic) Reflective sheeting series!

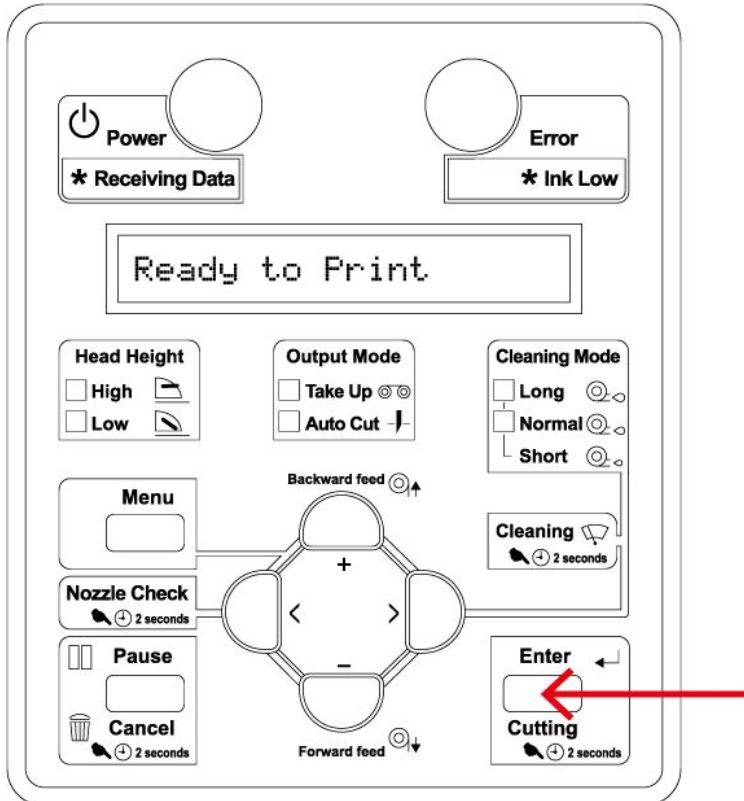

7. Cleaning Mode Indicator

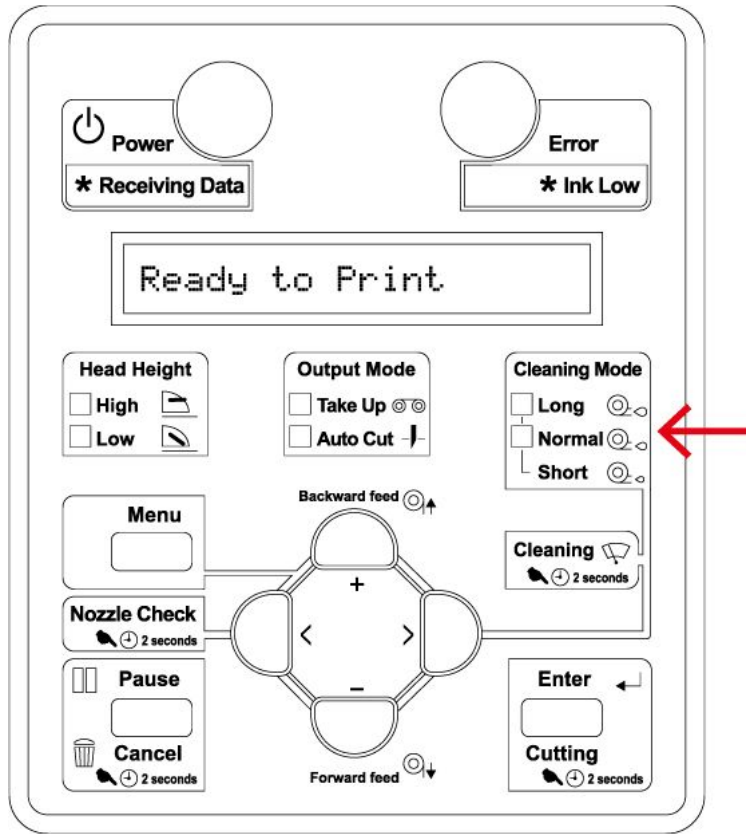

Short Cleaning Cycle Indicator

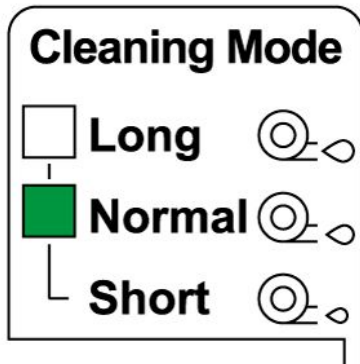

Normal Cleaning Cycle Indicator

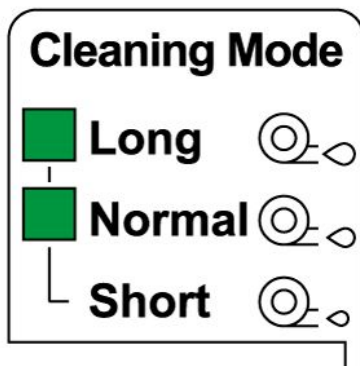

Long Cleaning Cycle Indicator

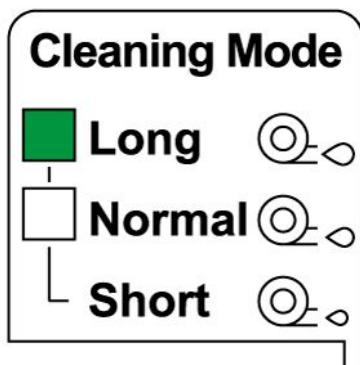

8. Error Indicator

When serious errors occur, the LED will blink orange and errors are reported on the display. Examples are Ink Low, Ink End or No Cartridge message.

Ink Low

[125] Ink Low means the cartridges or bags in slot positions 1, 2 and 5 are almost empty and you should start preparing new ones.

Ink End

[348] Ink End means the cartridges or bags in positions 3, 4 and 8 are empty and the printer is running on the sub tanks. Immediately replace them to prevent the print from being interrupted!

No Cartridge

[26] NoCartridge means no cartridges or bags are inserted or recognized in slot positions 2 and 6 by the printer.

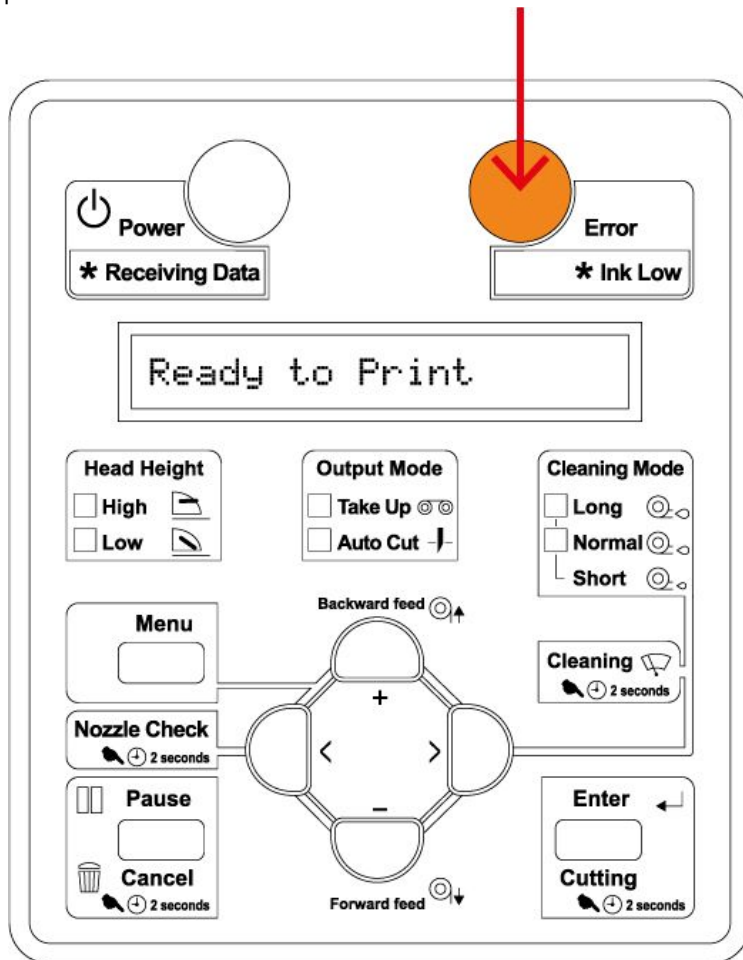

9. Online Menu

Press Menu Button during printing

1	Temperature	Only to check temperature
2	Pre Heater	Change Pre Heater
3	Platen Heater	Change Platen Heater
4	Dryer	Change Dryer
5	PF Micro Adj.	Change step setting
6	Backup	Save Parameter
7	Job Status	Info about remaining job

The above Avery Dennison literature provides information to the user for proper application, storage and other requirements. Please refer to Product Data Bulletins or your local Avery Dennison Representative for warranty information. Find the latest information on the Avery Dennison website, www.reflectives.averydennison.com. We encourage you to check our website periodically for updates.

All statements, technical information and recommendations about Avery Dennison products are based upon tests and information believed to be reliable, but do not constitute a guarantee or warranty of any kind. All Avery Dennison products are sold with the understanding that Purchaser has independently determined the suitability of such products for its intended and other purposes.

For technical questions, please contact:

North America: reflective.tech.na@averydennison.com

Europe, Middle East & Africa: reflective.tech.emea@eu.averydennison.com

Asia Pacific: reflective.tech.ap@ap.averydennison.com

South America: reflective.tech.sa@averydennison.com